

ROCKSOLID[®] ANCHOR

OWNER MAINTENANCE MANUAL

(not for initial installation)

BUILDER/INSTALLER: Please give these instructions to the Facilities Manager for future reference.

NOTE: In order to protect your investment and extend the life of your RockSolid Anchor, we recommend the use of a Safety Cap (Part #20-191) when the anchor is not in use. If one was not provided to you at time of installation, please contact your pool professional to order one for you.

ROCKSOLID® ANCHOR

WEDGE REMOVAL & REASSEMBLY INSTRUCTIONS

When removing a basketball game or other product from a RockSolid Anchor it is important to follow these instructions to avoid disassembling the wedge anchor assembly.

1. Loosen bolt using a 1/4" Allen wrench, turning in a counter-clockwise direction two-full turns, as seen from looking down.
2. Lift straight-up, remove the product and re-tighten the bolt with the Allen wrench turning in a clockwise direction two-full turns. Be careful not to over tighten.

REASSEMBLY OF WEDGE INTO ANCHOR:

1. Remove the wedge components from the inside of the anchor. There are two complete pieces; **1** the middle wedge brass, and **2** the top/bottom single post brass. Place the middle wedge in-between the posts as shown in FIGURE 2.
2. Locate the two pins on the backside of the wedge. FIGURE 2. The pins align into the two slots on the back inside wall of the anchor. FIGURE 3

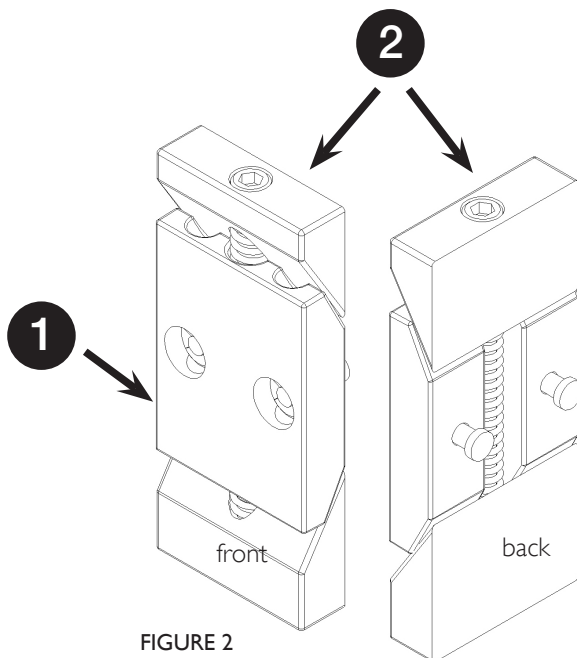

FIGURE 2

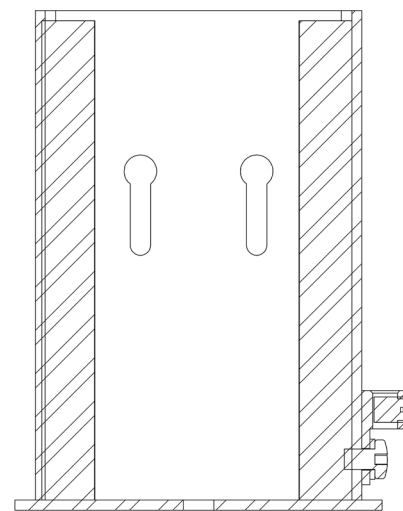

FIGURE 3

WEDGE REMOVAL & REASSEMBLY INSTRUCTIONS

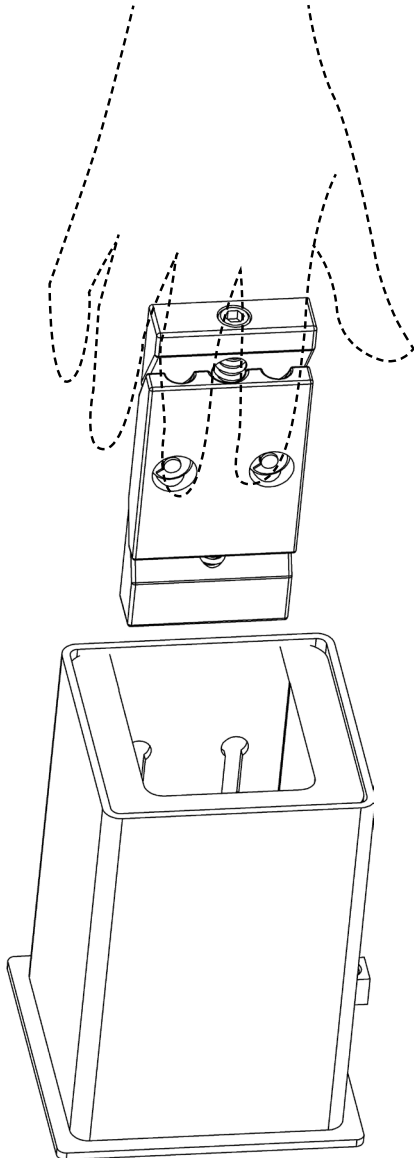

FIGURE 4

3. Position the wedge over the top of the anchor top up. FIGURE 4

NOTE: The top of the wedge has the socket for the Allen wrench.

4. While depressing the spring buttons on the front side of the wedge, align the pins to the slots on the inside of the anchor and slide into the slot openings, using a downward motion move the wedge into the locked position at the bottom of the slot.
5. If the product is not being reinserted into the anchor, once the wedge is in place tighten it using the Allen wrench. Insert the wrench into the anchor bolt and turn clockwise one turn to gently tighten the wedge into place. FIGURE 5. NOTE: Do not over-tighten.

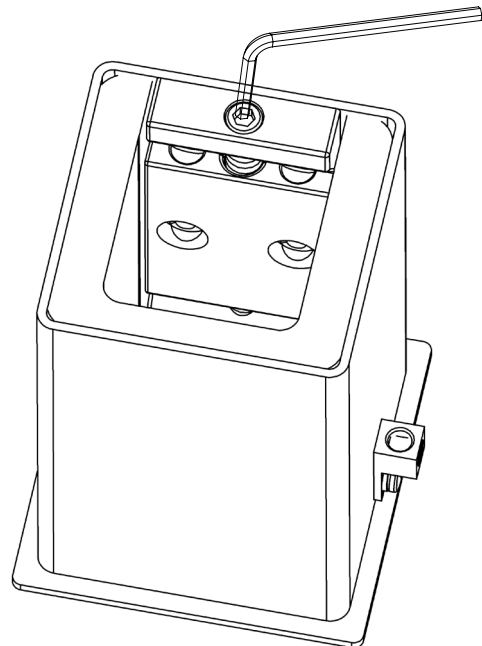

FIGURE 5

6. If the product is being reinserted into the anchor, place product into anchor making sure that the products frame rests completely on the bottom of the anchor with the forward edge facing the pool.
7. Tighten using the Allen wrench in the clockwise direction until anchor wedge contacts the frame and no forward or backward motion can be felt. When tightening anchor wedge, never exceed 8-ft lbs. of torque. Anchor bolt should be snug, but never over tighten.
8. Make sure that the opening size directly adjacent to anchor bolt is between 2-9/16" (65mm) and 2-5/8" (66.7mm) wide.

NOTE: The opening size should never exceed 2-5/8" (66.7mm) or the anchor will disassemble.

REFER TO PRODUCT INSTALLATION MANUAL FOR COMPLETE
INSTALLATION REQUIREMENTS AND INSTRUCTIONS.