

# Commercial Ring

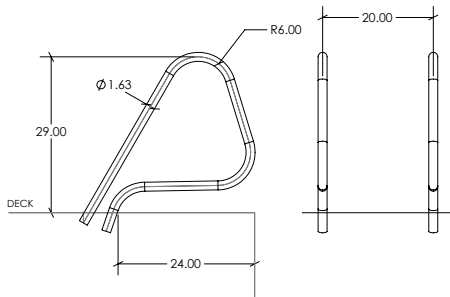

- Tubing: 1.625" OD
- Wall Thickness: .065"
- Stainless Steel: 304
- Recommended anchors: 34-305A or 34-306A
- Recommended escutcheons: 8-420 (included) or 8-420-CP (order separately)
- Sold as pairs



Model No.	Description	Shipping			
		Weight	Length	Width	Height
CRH-100	Rails only, no anchors or escutcheons	14 lbs 6kg	40" 102cm	32" 81cm	4" 10cm
CRH-100A	Rails with Aluminum Anchor with escutcheons	16 lbs (2 boxes) 7kg	32"	22"	4"
			81cm	56cm	10cm
			24" 61cm	8" 20cm	5" 13cm
CRH-100B	Rails with Bronze Anchor with escutcheons	18 lbs (2 boxes) 8.1kg	32"	22"	4"
			81cm	56cm	10cm
			24" 61cm	8" 20cm	5" 13cm

## Parts & Accessories

- 34-305A Aluminum Anchor, Complete
- 34-306A Bronze Anchor, Complete
- 8-415A Gibraltar Wedge Retro Fit Kit
- 8-420 Double Escutcheon Plate, chrome plated plastic
- 8-420-CP Double Escutcheon Plate, chrome plated brass