

# PoolSonix Door/Gate Alarm (PSX-320)

## INTRODUCTION

The PoolSonix Door/Gate Alarm is designed to sound an alarm in the event of unauthorized access to the pool environment via a gate or door using a PoolSonix Door/Gate Alarm. The alarm contains three parts: Base unit, Bypass Switch and Magnetic Switch.

Authorized users push the bypass switch to temporarily disengage the alarm allowing access to the pool environment. The door/gate must be closed within fifteen seconds or the alarm will sound.

### **WARNING**

When the door/gate is opened without pushing the bypass switch the alarm will sound. The unit may be configured to alarm immediately or after a seven second delay. When configured for immediate alarm, the alarm will sound when the door/gate is opened. When configured for a seven second delay, the alarm will sound if the door/gate is opened and not closed within seven seconds. Installers/Users should confirm that the seven second delay is appropriate for the application noting that gates that are spring loaded or close automatically may not be an appropriate use of the seven second delay.

The PoolSonix Door/Door/Gate Alarm is designed to alert a responsible adult to unwanted entry through the door/gate. IT IS NOT A LIFE SAVING DEVICE. Active adult supervision is the first and most important layer of protection for any pool. The PoolSonix Door/Gate Alarm is not a replacement for active adult supervision or a

direct replacement for any other approved layer of protection including, but not limited to, lifeguards, fences, gates pool covers and locks.

The Door/Gate Alarm can be powered either by 4 AA 1.5V alkaline batteries or AC adapter (not included).

### **WARNING**

When the battery level becomes low, the LED will flash once every 30 seconds, and the system will enter shutdown mode. When this occurs, replace the batteries as soon as possible or connect with an AC adapter. It is recommended that batteries be changed once a year.

## INSTALLATION

Battery Installation:

1. Remove bottom screw and slide mounting plate of base unit. (FIGURE 1).
2. Remove screws from each corner of the battery cover and remove cover.
3. Insert 4 AA 1.5V batteries, ensuring correct polarity (FIGURE 2).
4. Replace battery cover and screws.

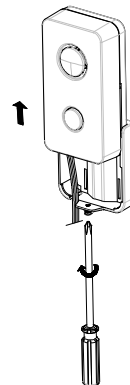

FIGURE 1

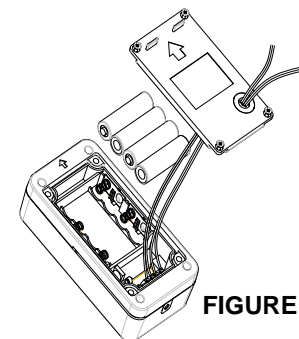

FIGURE 2

**Note:** Battery cover must be tightly screwed onto the base to prevent water from getting into the battery compartment.

## SELECT MOUNTING LOCATION

### Base Unit

The Base Unit should be mounted at a height that is out of the reach of small children and can be reached by an adult. For gates, it must be mounted on the outside of the gated area. For doors, the base unit is mounted on the inside wall next to the door frame closest to the door knob.

**NOTE:** Refer to local (city, county and state) ordinances for mounting height specifications where applicable.

The Base Unit should be mounted on the post opposite the hinged side of the door/gate.

### Square Post/Wall Mounting

1. Place the mounting bracket at the appropriate height. Using the screw holes mark the mounting surface with a pencil.
2. Where marked, drill holes using appropriate size drill bit.
3. Screw mounting bracket onto post/wall. Ensure that the screws are flush with bracket. (For concrete, insert plastic anchors into holes and attach mounting plate with screws)
4. Slide the base down to the bracket (FIGURE 3).

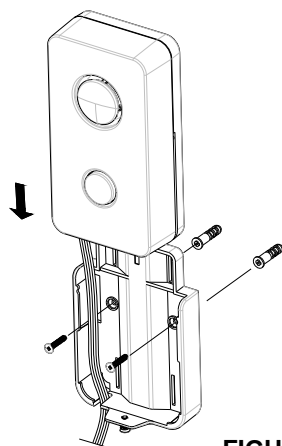

FIGURE 3

### Round Post Mounting

1. Place the mounting bracket at the appropriate height.
2. Insert two stainless steel hose clamps (not included) through slots in mounting bracket around the post.
3. Tighten hose clamps securely
4. Slide the base down to the bracket (FIGURE 3).

### Bypass Switch

The Bypass Switch must be mounted on the inside of the gated area or on the outside wall of the door being protected. Mount the Bypass Switch to the post/wall using either screws provided (FIGURE 4) or double-sided foam tape (FIGURE 5)

1. Place the bypass switch at the appropriate height. Be sure the button for the bypass switch is at the same height as the button on the base unit of the door/Door/Gate Alarm. Using the screw holes, mark the mounting surface with a pencil. One half inch (1/2") above the bottom screw hole mark, mark an additional spot to drill a hole for the wire lead that connects to the base unit.
2. Where marked, drill holes using appropriate size drill bit.
3. Screw bypass unit onto post/wall using hardware provided.

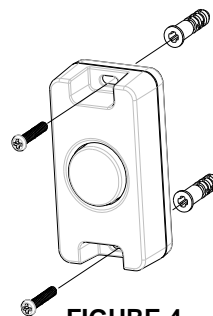

FIGURE 4

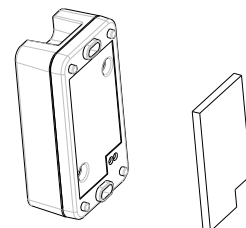

FIGURE 5

## Magnetic Switch

1. The Magnetic Switch should be mounted as close to the Base Unit as possible. Depending upon the width of the post or the width of the door frame, the Magnetic Switch may be mounted either next to, above or below the Base Unit (FIGURE 6 or 7). Mount the Magnet to the gate or door and the Switch to the post or door frame.

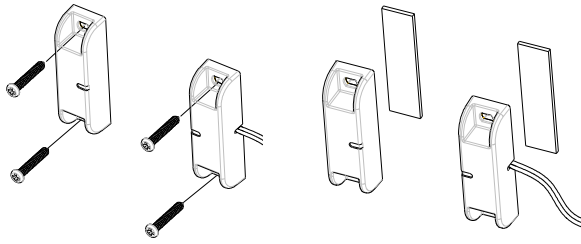

FIGURE 6

FIGURE 7

2. The arrows on the Magnet and Switch must be aligned. The gap between Magnet and Switch must be less than one half inch (1/2") (FIGURE 8)

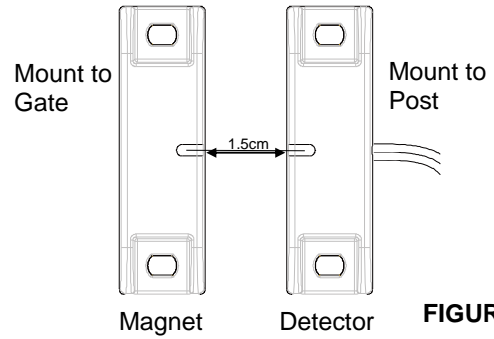

FIGURE 8

The following diagrams (Figure 9a-b) illustrate the correct mounting of the Door/Gate Alarm.

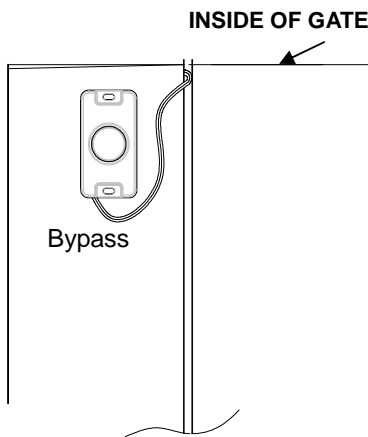

FIGURE 9a

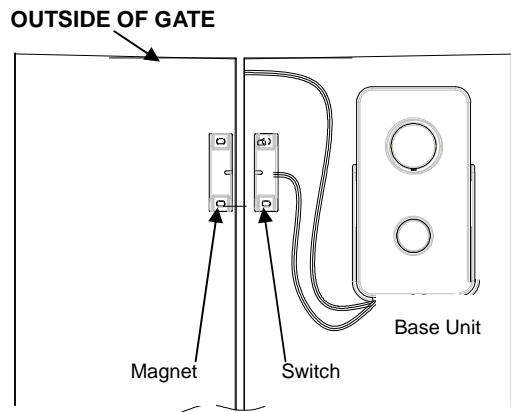

FIGURE 9b

The following diagrams (Figure 9c-d) illustrate the correct mounting for the Door Alarm.

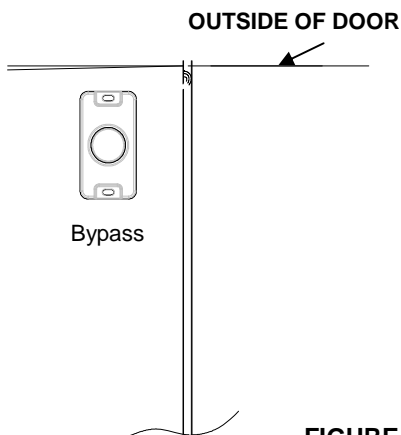

FIGURE 9c

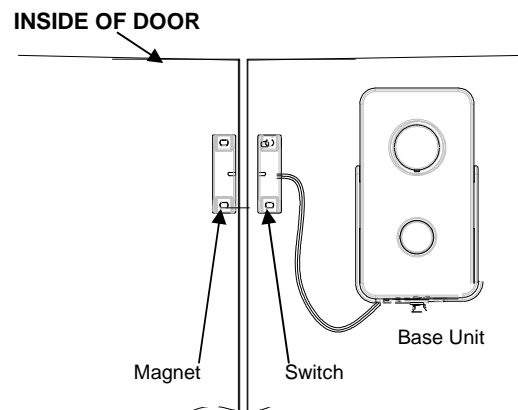

FIGURE 9d

## CONNECTIONS

Connect the magnetic switch and the bypass switch to the terminal block in the Base Unit. The left terminal is for the Bypass Switch. The right terminal is for the Magnetic Switch (FIGURE 10). Insert the wire leads into the appropriate terminal block and tighten with a small screwdriver. Allow enough lead length to connect switches securely to terminal block. Trim as necessary.

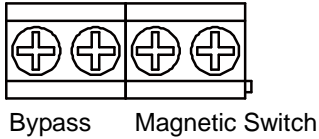

FIGURE 10

## DOOR/GATE ALARM CONFIGURATIONS

The Door/Gate Alarm may be configured four ways –

### Stand Alone

As installed per the instructions provided above, the Door/Gate Alarm will act as a stand-alone device. The Door/Gate Alarm Base Unit will sound when the gate is opened without pressing bypass switch.

### Door/Gate Alarm Integrated with PoolSonix Pool Alarm System

The Door/Gate Alarm may be configured for use with the PoolSonix Pool Alarm System. The Door/Gate Alarm and the Interior Siren/Strobe will both alarm when the gate is opened and the bypass switch is not pressed. The Door/Gate Alarm and Interior Siren/Strobe from the PoolSonix Pool Alarm must be enrolled with each other for the system to operate correctly. See the PoolSonix Pool Alarm System installation and operating instructions for additional information regarding enrollment procedures.

### Learn Mode

To put the Interior Siren/Strobe into Learn Mode, press the learning key for three seconds. The unit will beep three times and the LED will flash green when in Learn Mode. See PoolSonix Pool Alarm Installation and Operating instructions for further details.

### Door/Gate Alarm Integrated with Interior Siren/Strobe

The Door/Gate Alarm and Interior Siren/Strobe can function as a multi-area notification system. The Door/Gate Alarm and Interior Siren/Strobe must be enrolled together for system operation.

### Learn Mode

To put the Interior Siren/Strobe into Learn Mode, press the learning key for three seconds. The unit will beep three times and the LED will flash green when in Learn Mode. See PoolSonix Pool Alarm Installation and Operating instructions for further details.

To enroll the Door/Gate Alarm, the Interior Siren/Strobe must first be in Learn Mode. Then press and hold the

learn key on the Door/Gate Alarm for three seconds to enter learn mode. A 30-second countdown will start during which the LED will be flash once a second. If enrollment is successful, the LED will briefly flash on. If enrollment is unsuccessful, the LED will flash rapidly three times before exiting learn mode.

The Interior Siren/Strobe should be mounted indoors on the interior wall closest to the Door/Gate Alarm approximately 7 to 8 feet high; adjacent to the door that provides access to gated area. See Interior Siren/Strobe section of the PoolSonix Pool Alarm System Installation and Operating instructions for further information.

### **Door/Gate Alarm, Siren/Strobe and Universal Bridge**

The Door/Gate Alarm, Interior Siren/Strobe and Universal Bridge can function as a multi-area notification system that is integrated with a security or home automation system. Installation of the Universal Wireless Bridge should be done by a certified security industry professional and is required in order to have the Door/Gate Alarm connect to the security or home automation panel. The Door/Gate Alarm, Interior Siren/Strobe and Universal Bridge must be enrolled together for system operation.

After the Universal Wireless Bridge has been enrolled, the Door/Gate Alarm can be enrolled. To enroll the Door/Gate Alarm, put the Interior Siren Strobe into Learn Mode by pressing the learning key for three seconds. The unit will beep three times and the LED will flash green. Then press and hold the learn key on the Door/Gate Alarm for three seconds to enter learn mode. A 30-second countdown will start during which the LED will be flash once a second. If enrollment is successful, the LED will briefly flash on and the unit will beep once. If enrollment is unsuccessful, the LED will flash rapidly three times and rapidly beep three times before exiting learn mode.

## LED INDICATIONS (BY PASS BUTTON ON BASE UNIT)

| Event                                  | Status of Learning Key | LED Status  | Sound Status  |
|--|------------------------|---|---|
| Press learning key to enter learn mode | Hold key for 3 seconds | LED will illuminate steadily.                     | One beep every second and for 4 seconds             |
| In learning mode                       |                        | LED flashes repeatedly                            | One beep every 3 seconds during 30-second countdown |
| Successful enrollment                  |                        | LED flashes once                                  | One beep  |
| Unsuccessful enrollment                |                        | LED flashes 3 times rapidly                       | 3 rapid beeps                                       |
| Battery Installation                   |                        | LED will flash once every 3 seconds for 1 minutes |   |

## JUMPER SETTINGS

There are three jumpers. The functions are listed as follows:

### 1. Mode Jumper (Top)

Instant Mode and Delay Mode are two modes available for selection.

**Instant Mode:** With the jumper removed, the Door/Gate Alarm will sound unless the By Pass Switch is pressed.

**Delay Mode:** With the jumper in place, the Door/Gate Alarm will sound if the gate is opened and not closed within seven seconds.

### 2. Function Jumper (Middle)

When used with PoolSonix Pool Alarm System, the Door/Gate Alarm can be configured to trigger relay #2 or #3 on the Universal Bridge. With the Jumper in place, it will trigger relay #3

and when the Jumper is removed, it will trigger relay #2.

### 3. Volume Jumper (Bottom)

There are two loudness settings for the alarm: low and high. Remove jumper for lower volume alarm. Leave the jumper in place for loudest alarm.

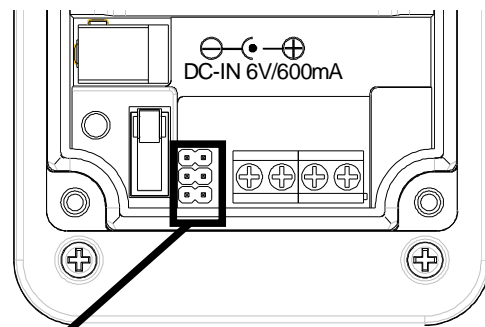

Jumper in place

**Note:**

To change Function/Mode/Volume, simply remove the jumper.

## TROUBLESHOOTING

| Symptom                                   | Possible Cause   | Recommendation   |
|---|--|--|
| Learning key or Bypass Switch not working | Batteries have not installed properly or low battery power | Check batteries are installed correctly or replace batteries |
|   | Adapter connection is poor                                 | Reconnect the AC adapter                                     |
| No alarm after gate opening               | Gap between Magnetic Switch is greater than ½ "            | Ensure Magnetic Switch is properly installed                 |
|   | Door/Gate Alarm is in Delay Mode                           | Check Mode Jumper  |

## SPECIFICATION

|                          |   |
|--------------------------|---|
| Power Adapter (optional) | 600 mA@6V DC                            |
| Battery Type             | 1.5V AA x 4                             |
| Battery Life             | About 1 year @ 77°F (25°C) standby mode |
| Operating Frequency      | 923.00MHz                               |

\*Specifications are subject to change without prior notice.

A501111594R



### WARNING:

Do not dispose of electrical appliances as unsorted municipal waste, use separate collection facilities.

Contact your local government for information regarding the collection systems available.

If electrical appliances are disposed of in landfills or dumps, hazardous substances can leak into the groundwater and get into the food chain, damaging your health and well-being.

When replacing old appliances with new once, the retailer is legally obligated to take back your old appliance for disposal at least for free of charge.

## Warranty

S.R. Smith, LLC warrants to the original retail purchaser that products manufactured by S.R. Smith or manufactured under licensed agreement with S.R. Smith, when properly assembled and installed in accordance with S.R. Smith's assembly and installation instructions, and properly used and maintained, shall be free from defects in material and workmanship for a period of two (2) years from the date of original manufacture. The original retail purchaser must follow the procedure set forth below when submitting a warranty claim. S.R. Smith will repair or replace, at its option, the product, and return it to the owner freight prepaid. Determination of repair or replacement shall be solely at the discretion of S.R. Smith.

The warranty is non-transferable and is subject to the following terms and conditions:

S.R. Smith shall not be responsible for the cost of removal or replacement of any defective S.R. Smith product, nor for any other expenses or for damages which might be incurred in such removal and replacement.

S.R. Smith shall not be liable for any consequential, special or incidental damages, including, but not limited to any damages for loss of use of pools or injury to person or property, whether arising from S.R. Smith's sole negligence or otherwise, and any liability therefore is hereby specifically disclaimed and excluded. Some states do not allow the exclusion or limitation of incidental, special or consequential damages, so the above limitation or exclusion may not apply to you. This warranty gives you specific legal rights and you may also have other rights, which may vary from state to state. The warranty is extended to, and enforceable only by the original retail purchaser.

THE WARRANTY SET FORTH HEREIN IS IN LIEU OF ALL OTHER WARRANTIES, EXPRESSED OR IMPLIED, WHICH ARE HEREBY DISCLAIMED AND EXCLUDED, INCLUDING WITHOUT LIMITATION ANY WARRANTY OF MERCHANTABILITY OR FITNESS FOR A PARTICULAR PURPOSE OR USE.

THE SOLE AND EXCLUSIVE REMEDIES FOR BREACH OF ANY AND ALL WARRANTIES WITH RESPECT TO THE PRODUCTS SHALL BE LIMITED TO REPAIR OR REPLACEMENT AT S.R. SMITH'S DESIGNATED FACTORY OR IN PLACE AT S.R. SMITH'S OPTION. IN NO EVENT SHALL S.R. SMITH'S LIABILITY EXCEED THE ENTIRE AMOUNT PAID TO S.R. SMITH BY THE ORIGINAL PURCHASER FOR THE FAILED OR DEFECTIVE PRODUCT.

IN NO EVENT SHALL S.R. SMITH BE LIABLE FOR ANY INCIDENTAL, CONSEQUENTIAL, SPECIAL, INDIRECT, PUNITIVE OR EXEMPLARY DAMAGES OR LOST PROFITS FROM ANY BREACH OF THIS LIMITED WARRANTY OR OTHERWISE.

No representative of S.R. Smith, nor any of its agents, distributors or dealers has any authority to alter in any manner the terms of this warranty and S.R. Smith is not responsible for any undertaking, representation or warranty made by any other person beyond the warranty expressly set forth in this warranty.

For more detailed warranty information visit [www.srsmith.com](http://www.srsmith.com).

Printed in ROC

(PSX-320 4-28-10)



S.R. Smith, LLC

1017 SW Berg Parkway

Canby, Oregon 97013

[www.srsmith.com](http://www.srsmith.com)

1-800-824-4387

# Door/Gate Alarm PSX-320

## PRODUCT LAYOUT

### Door/Gate Alarm

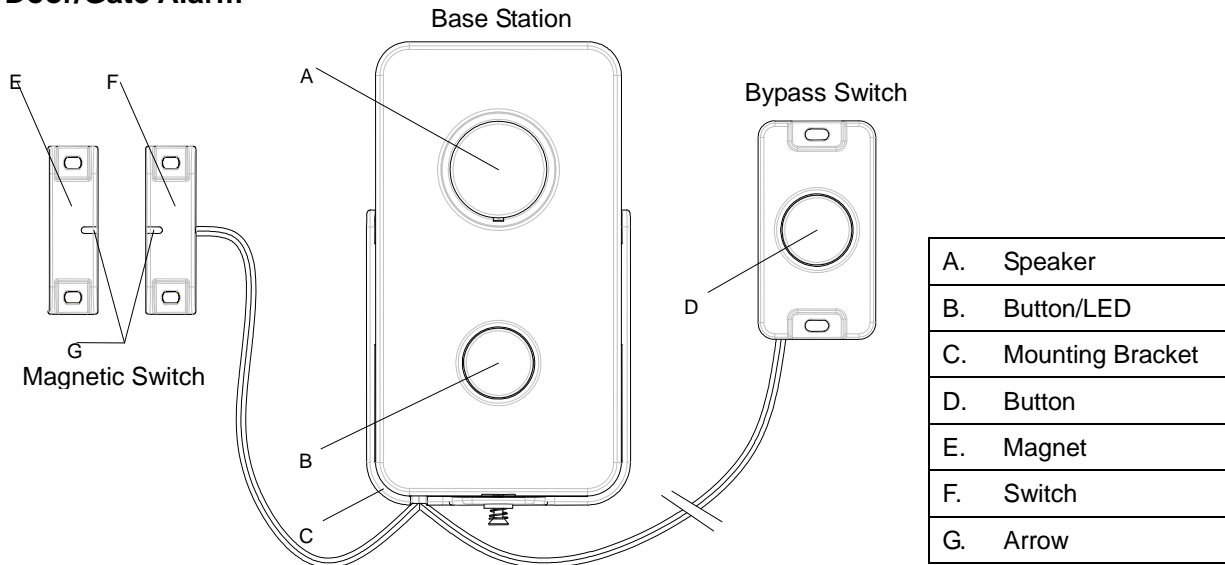

### Inside view of Base Unit (Battery Compartment)

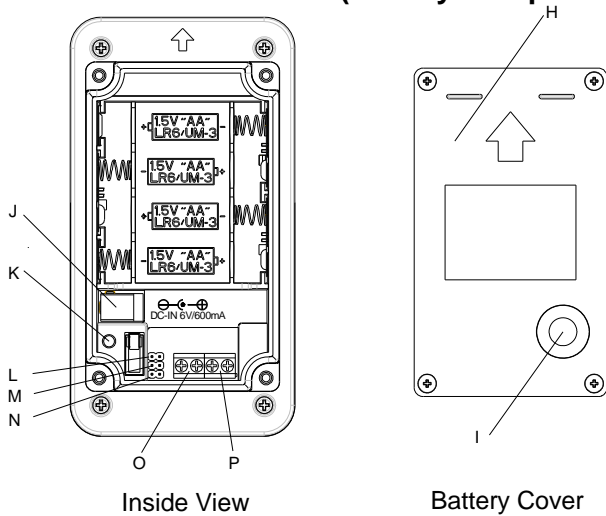

### Mounting Package

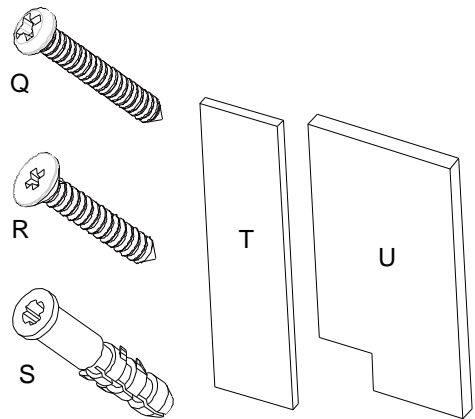

|    |                      |    |                           |
|----|----------------------|----|---------------------------|
| H. | Battery Cover        | M. | Mode Jumper Link          |
| I. | Cable Hole           | N. | Sound Jumper Link         |
| J. | DC Jack              | O. | Bypass Switch Connector   |
| K. | Learning Key         | P. | Magnetic Switch Connector |
| L. | Function Jumper Link |    |                           |

|    |  |
|----|--|
| Q. | Round Screw x 6                                    |
| R. | Flat Screw x 2                                     |
| S. | Plastic Wall Plug x 4                              |
| T. | Double Side Foam Tape x 2<br>(for Magnetic Switch) |
| U. | Double Side Foam Tape x 1<br>(for Bypass Switch)   |