



**Product Name:** Straight ADA Transfer Rails with Flanges

**Part Number:** TR-12A, TR-14A, TR-16A, TR-18A

**General Notes:**

The **Straight ADA Transfer Rails with Flanges** are constructed from polished stainless steel. Flanges are included to mount the bar to the pool wall. All mounting hardware is included. These rails are available in overall lengths of 12”, 14”, 16” and 18” (304.6mm, 355.3mm, 406.1mm and 456.9mm) and special order rails in alternate lengths are also available.

**Application:**

These units are intended for use at commercial and competitive installations as ADA compliant transfer wall grab rails. The rails can be used in most geographic areas.

**Specifications:**

- 1 Rail: These transfer rails are constructed from a 1.50” O.D. x .120 wall (38.1mm x 3.05) type 316L polished stainless steel tubing.
- 2 Flange: The included flanges are made from .117” thick (2.97mm) type 316L polished stainless steel. They measure 4.50” (114.21mm) in diameter and raise .50” (12.70mm) beyond the wall. The flanges are drilled to accept three (3) included 3/8-16 UNC anchor bolts.

**Additional Product Numbers and Shipping Weight:**

Model Number	Description	Shipping Weight
TR-12A	12” Straight ADA Transfer Rail with Flanges	5.85 lbs (2.65kg)
TR-14A	14” Straight ADA Transfer Rail with Flanges	6.12 lbs (2.78kg)
TR-16A	16” Straight ADA Transfer Rail with Flanges	6.40 lbs (2.90kg)
TR-18A	18” Straight ADA Transfer Rail with Flanges	6.70 lbs (3.04kg)

Specification Number:	SRS-617		<b>S.R. Smith, LLC</b> P.O. Box 400, 1017 SW Berg Parkway Canby, Oregon 97013 Tel: (888) 677-7776 (503) 266-2231 Fax: (503) 266-4334 www.srsmith.com
Product Description:	Straight ADA Transfer Rails with Flanges		
S.R. Smith Part Number:	TR-12A, TR-14A, TR-16A, TR-18A		
Revision:	A	Date: 06/21/12	
Written By:	D. Johnson	Date: 06/21/12	
Approved By:		Date:	
Page 2 of 2	Proprietary and confidential: The information contained in this specification is the sole property of S.R. Smith LLC. Any reproduction in part or whole without the written consent of S.R. Smith LLC is prohibited.		



S.R. Smith LLC

# Product Specifications - Drawing

## Straight ADA Transfer Rails with Flanges

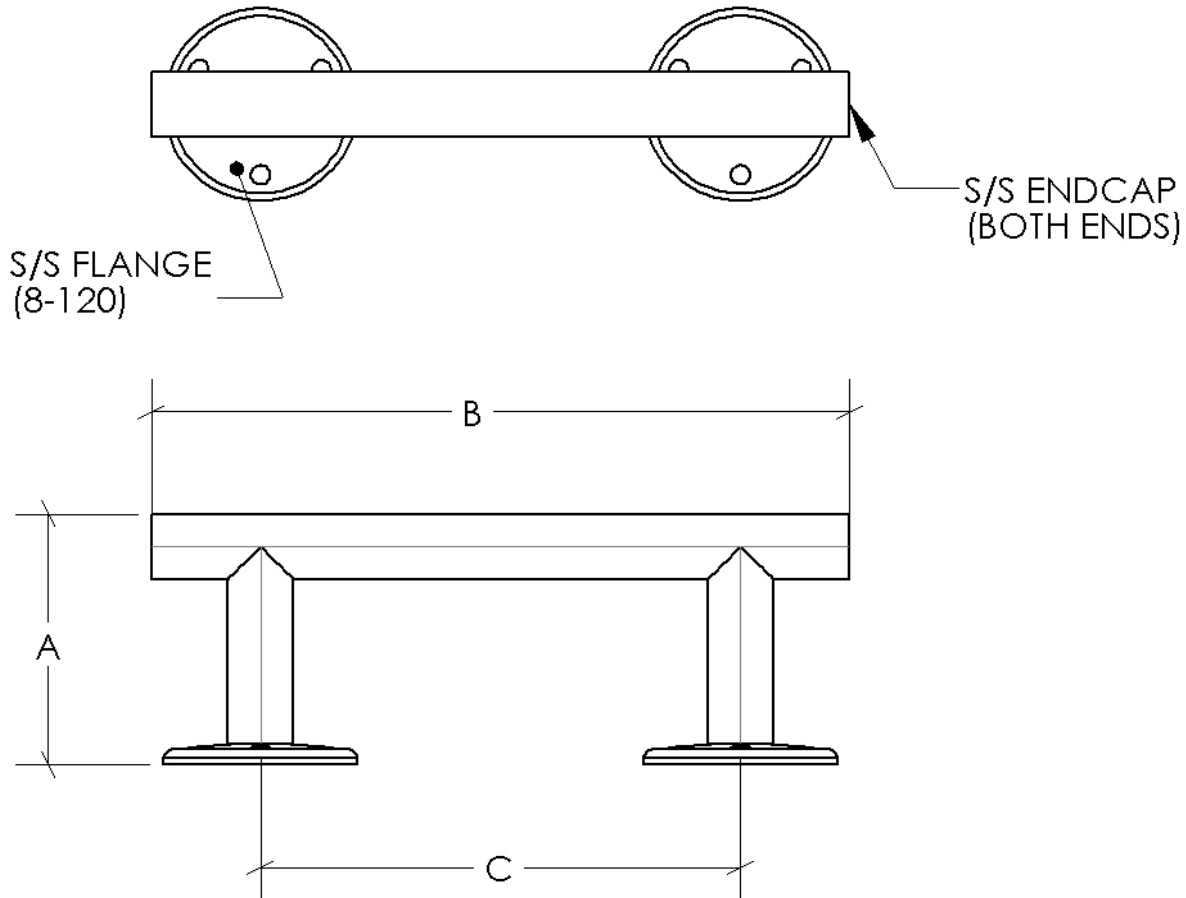

Model Number	A	B
TR-12A	5.75"	12.00"
TR-14A	5.75"	14.00"
TR-16A	5.75"	16.00"
TR-18A	5.75"	18.00"

Specification Number:	<b>SRS-617</b>		
Product Description:	<b>Straight ADA Transfer Rails with Flanges</b>		
S.R. Smith Part Number:	<b>TR-12A, TR-14A, TR-16A, TR-18A</b>	Scale:	NTS
Revision:	A	Date:	06/21/12
Written By:	D. Johnson	Date:	06/21/12
Approved By:		Date:	
Page 1 of 2	Proprietary and confidential: The information contained in this specification is the sole property of S.R. Smith LLC. Any reproduction in part or whole without the written consent of S.R. Smith LLC is prohibited.		

**S.R. Smith, LLC**  
P.O. Box 400, 1017 SW Berg Parkway  
Canby, Oregon 97013  
Tel: (888) 677-7776 (503) 266-2231  
Fax: (503) 266-4334  
www.srsmith.com