

Global Anti Goal SNR 1.2m & JNR Assembly Instructions:

Tools Required: 13mm Spanner
6mm Hex Hand Tool
Soft Mallet
Philips Head Screwdriver



Before Starting the job (IMPORTANT NOTES):

- 1/ Open the cartons (2pc Cartons each 1pc Goal, marked 'Carton A' and 'Carton B') and lay out all the pieces on a clear & clean working area. Lay some protection on the ground to protect the Goal Frame and parts while you assemble the Goal. **Annex 1.0** Shows the contents of each Carton.
- 2/ There are a number of different sized Bolts and Washers included with the product assembly. Refer to the **Annex 2.0** Assembly Hardware Diagram (at end of document) in order to identify and locate the assembly hardware required for each step.
- 3/ The ALU Frame Inserts (B Below) are packed *inside* the Frame Bar cavities for protection while in transit. Simply pull half of the ALU Frame Inserts out up to the line indicated to use.
- 5/ The Front Frame bars (2pc) are identified by having the Anti Logo stickers attached to them from factory. The 2pc Rear Frame bars *do not* have the Anti Logo stickers attached to them.
- 6/ Review the **Annex 3.0** Goal frame parts to understand the basic layout of ALU parts before starting.
Parts Note: Pls refer to the Packing list (provided) for a complete and comprehensive parts list including an image of each part supplied.
- 7/ **Annex 4.0** shows the fully completed assembled goal, prior to Net install.

Global Anti Goal Key Parts:

Label	Part Name	Carton
A	Front Frame Bars (2pc)	B
B	Front & Rear Frame ALU Inserts (Inside the Frame)(2pc)	B
C	Rear Frame Bars (2pc)	B
D	Rear Frame Foam Bumper (1pc)	A
E	Front Frame Upright Bar 2pc)	B
F	Front Frame Side Bar (2pc)	B
G	Nylon Frame Corners (2pc)	B
GA	Nylon Hinge (2pc)	B
H	PVC Black Bows (2pc)	A
I	Nylon Flat Bars (2pc each side) (4pc Total)	A
J	Nylon Bow Holders (2pc)	A
K	SS Frame Cable (1pc)	A
L	PE Foam Floatation Pads (2pc)	A
M	Rear PE Bumpers (2pc)	A
N	Black HD Net	A
O	Nuts, bolts and washers	A

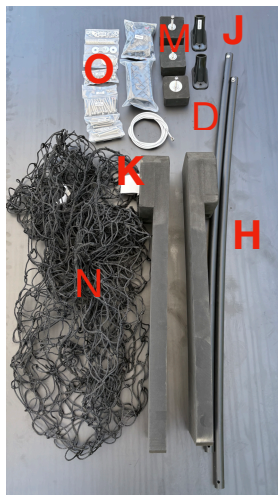

Carton A

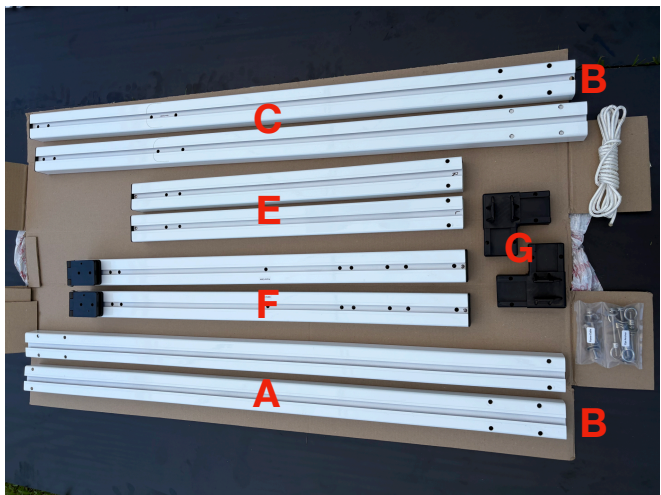

Carton B

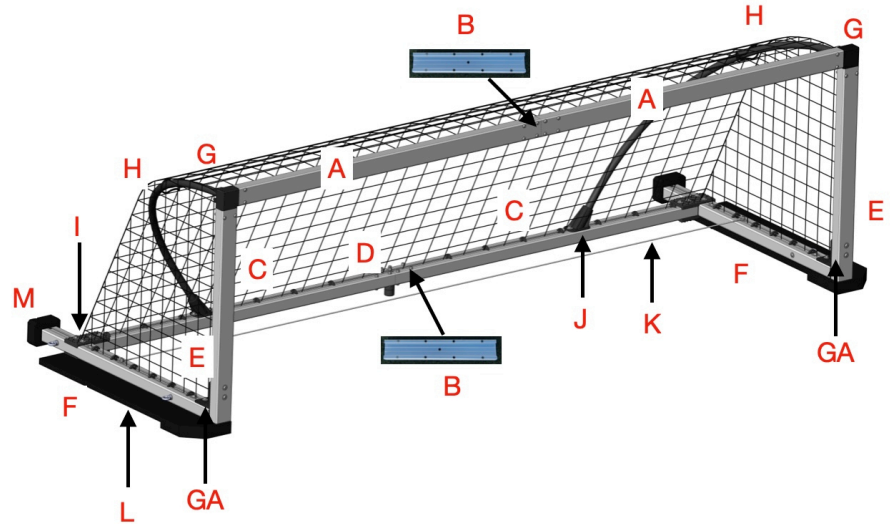

Step 1: Join and Assemble the 2pc Rear Frame Bars using the Frame ALU Insert & Rear Foam

Bumper:

Note: The ALU Frame Inserts are packed inside the Frame Cavities.

1. Locate the 2 x **Rear Frame Bars** (B below) that make up the Rear Frame Bar assembly, including 1 x **ALU Frame Insert** (A Below) and 8pc x 60mm **Button Head Bolts**, each with 2pc x 16mm **Washers** and 1pc x **LockNut** (shown B below). The rear frame bars do not have any Anti Logo stickers attached (the front frame bars do have the Anti Logo stickers attached).
2. Place the 2 pieces of the **Rear Frame Bars** (B below) on the ground with the Channel facing up, and make sure that the Rear Frame ends with the 4 x Predrilled holes are facing into each other (shown below).

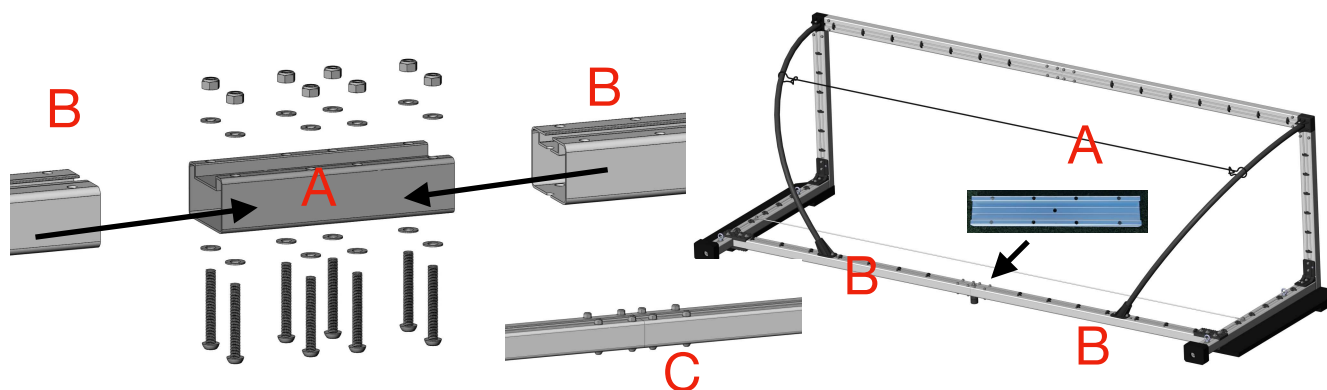

3. Insert 1pc **ALU Frame Insert** (A Above) into one end of the **Rear Goal Frame Bar** cavity with the 4 x Pre-drilled holes so that the predrilled holes in the ALU Insert line up with the 4 x Predrilled holes in the Frame end. Be careful not to push the insert in too far past the holes (see image below).
4. Insert the 4 x 60mm **Button head bolts**, with 1pc x 16mm **Flat Washer** on each side of the frame (2pc for each bolt) as shown above (A above) and tighten using tools provided. Make sure to place 1pc x 16mm **Washer** on each side of the frame (1pc under the bolt head, and 1pc under the LockNut on the other side of the frame). Hand tighten using the tools provided.
5. Push the **Rear Frame** with **ALU Frame Insert connected** into the other side of the **Rear Goal Frame bar**, and secure in place using 4 x 60mm **Button Head bolts**, with 8pc x 16mm **Flat Washer** and 4pc **LockNuts** and tighten firmly using tools provided. There is 1pc x 16mm **Flat Washer** each side of the Frame. Assembled part is shown in C Above.
6. Locate the pre-assembled **Rear Frame Foam Bumper** (A Below). The Rear Frame Bumper has the larger Flat Washer pre-installed compared to the other two. Locate the Frame Bumper hole in the centre of the **Rear Goal Bar Frames** (C Below). To install the bumper first remove the pre-installed **LockNut** and both the 16mm and 24mm **Flat Washers**, leaving the 50mm Flat Washer and Button head bolt attached (D below). Then push the bolt through the Rear Frame bar as shown below (E Below). Then re-install in order 1pc x 24mm **Flat Washer**, 1pc x 16mm **Flat Washer** finally the **Nylon Lock Nut** (E Below). Tighten in place securely. The Bumper faces the opposite side of the ALU Channel, facing down towards the ground once the goal is assembled (E Below).

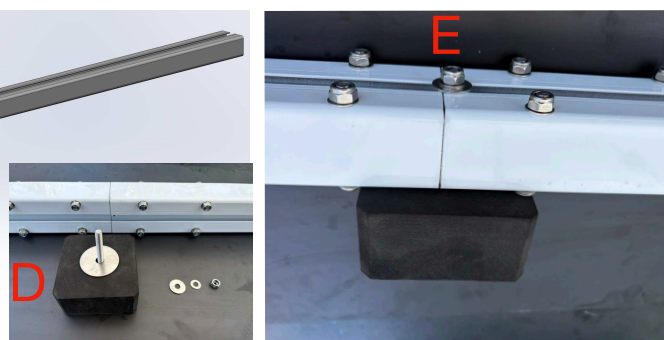
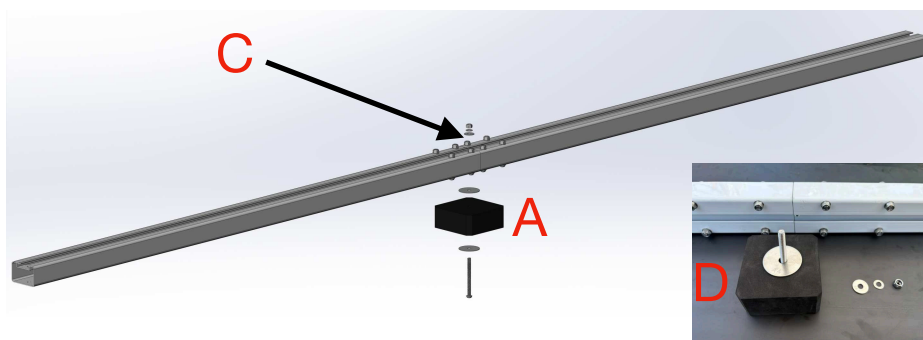

Step 2: Install the Nylon Bow Holders onto the Rear Frame:

1. Install the **Nylon Bow Holders (C Below)** facing outwards onto the **Rear Goal Frame**, using the **2pc x 70mm Button head bolts** with **2pc x 24mm Flat Washer** and **Nylon Lock Nuts** to secure each side. The correct positions for the Nylon Bow holders are pre-marked on the Rear Frame Bars. Make sure to place 1pc x 24mm Washer on each side of the Frame as shown.

Note: Due to the angle of the **Bow Holder**, install the outer **Bow Holder bolt, washers and LockNut** first, then slide the Bow holders into place under the top washer, and tighten the LockNut. Then install the inner bolts, washers and locknut to the Bow Holder and tighten. Repeat each side. **See E Below.**

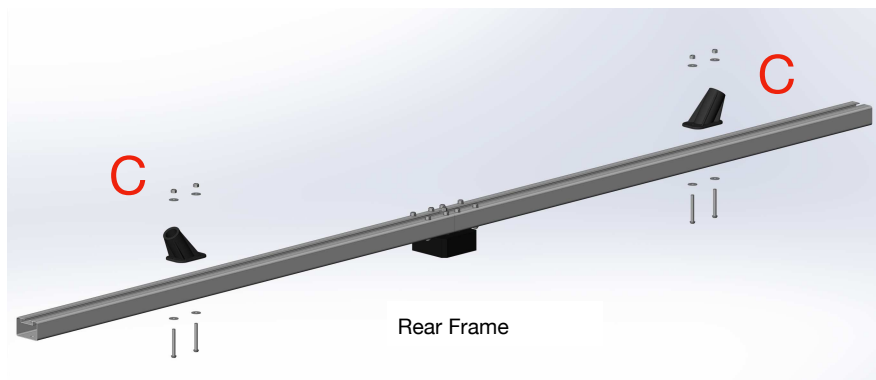

Note: Install this outer bolt, washer and locknut first, keep loose, and then slide the Bow Holder into position under the washer. Then tighten.

Step 3: Assemble the 2pc Front Goal Frame Bars:

Note: this step is similar to the Rear Frame bar assembly.

1. Place the 2 pieces of the **Front Frame Bars (C below)** on the ground with the Frame channel facing up, and the ends with the 4 x Predrilled holes facing into each other (D Below). The **Front Goal Frame bars** are identified as having the Anti Logo stickers attached to them.
2. Push the **ALU Frame insert (A Below)** into one side **Frame Bar** end first with the 4 x Pre-drilled holes so that the predrilled holes in the ALU Insert line up with the 4 x Predrilled holes in each Frame Bar (D Below).
Note: Be careful not to push the insert in too far past the holes.
3. Insert the **4 x 60mm Button head bolts** and place **1pc x 16mm Washer** each side of the frame into each end of the Frame and tighten using tools provided. Be careful not to over tighten.
4. Push the other side of the **Front Goal Frame bar** onto the **ALU Insert** so that the 4 x M8 holes are aligned, then insert the **4 x 60mm Button head bolts** and place **1pc x 16mm Flat Washer** each End of the Frame and tighten using tools provided. Be careful not to over tighten. See completed B Below.

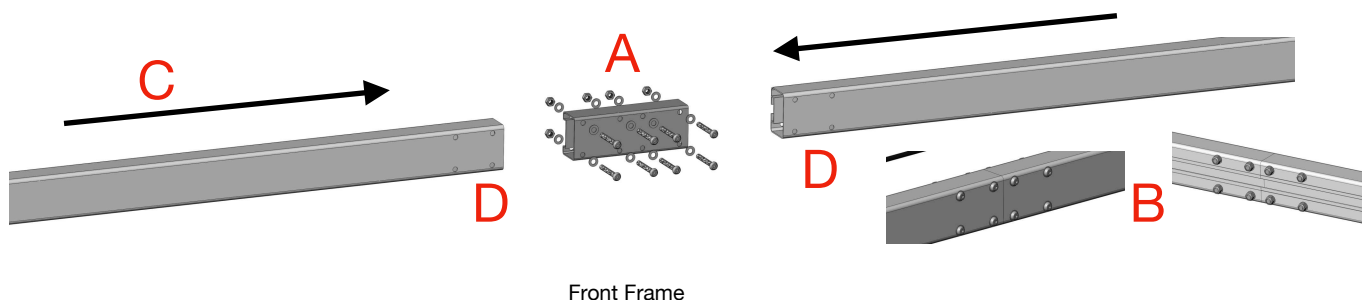

Step 3: Assemble the Side Goal Frame Bars:

1. Locate the **2pc Side Goal Frame Bars (A below)** and lay them on the ground as shown. Note the stickers pre-attached to the side bars from factory, showing the positions for each item.
2. The **Eye Anchor (B Below)** is pre-assembled with **100mm Button Head Bolt, 2pc x 24mm Flat Washers, 2pc x 16mm Lock Washers and M8 EyeBolt**.
- 3a. Remove the **M8 Eye Bolt from the Bolt**, and remove **1pc x 16mm Lock Washer** and **1pc x 24mm Flat Washer from the bolt**, push the **100mm bolt** through the 'Eye Anchor' marked positions. Ensure that the **Eye Anchor Bolt** is installed in opposing sides on each Side Bar (See A Below).
- 3b. Then reinstall **1pc x 24mm Flat Washer** (against the Goal frame) and **1pc x 16mm Lock Washer** (under the head of the Eye Bolt) and finally reinstall the **M8 Eye Bolt with Handle** to the bolt (**A Below**). Complete this step for all 4 eye anchors on both side bars.

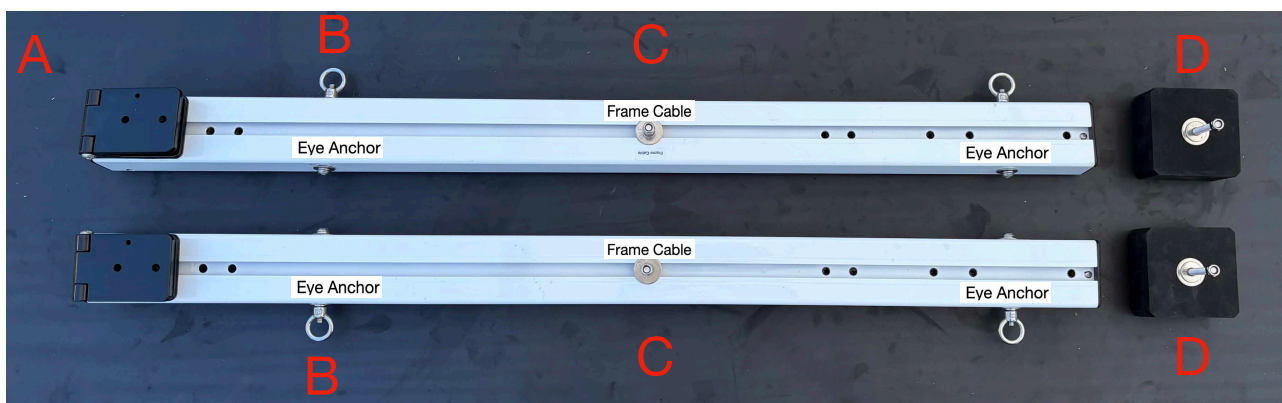

4. The **Frame Cable Bolt (C Above)** is shipped pre-assembled with **70mm Button Head Bolt, 1pc x 32mm Flat Washer, 1pc x 24mm Flat Washer, 2pc x 16mm Lock Washers and 1pc x LockNut.**
5. Remove the **LockNut, 1pc x 32mm Flat Washer and 2pc x 16mm Lock Washers** from the **60mm Frame Cable Bolt** and insert the Bolt through the underside of the Sidebar (**A Above**). Reinstall the **1pc x 32mm Flat Washer, 2pc x 16mm Lock Washers** and the **LockNut** to the Bolt on the top side of the Side Bar and tighten. Do not install the Frame cable to the bolt at this stage.
6. Locate the **Black PE Rear Bumper (D Above and Below)**. Locate the pre-assembled **1pc x 100mm Button Head Bolts**, with **1pc x 24mm Flat Washers, 1pc 32mm Flat Washer and LockNuts (D Below)**.
7. Remove **1pc x LockNut, 1pc x 24mm Flat Washer, 1pc 32mm Flat Washer** from the bolt, then insert the bolt through the underside of the Goal Frame (**E Below**). Reassemble **1pc x 32mm Flat Washer and 1pc x 24mm Flat Washer** and finally 1pc LockNut to the bolt and tighten firmly so that the foam bumper can not rotate.
8. Repeat this step for the other **Side Frame Bar (D Below)**. Ensure that both are securely tightened in place using the hand tools provided (**E + F Below**).

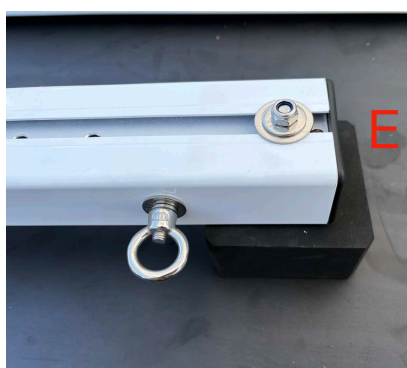
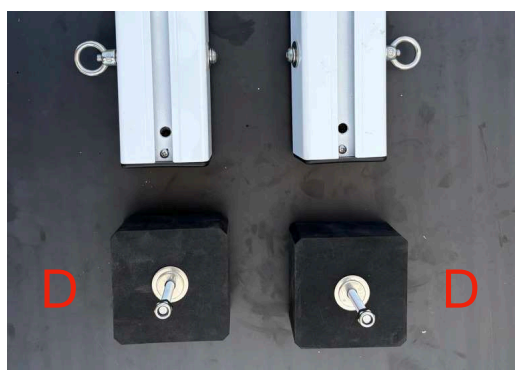

9. Locate the **2pc x Nylon Flat Bar Connectors (A Below)** to be installed into each of the **Side Frame Bars (B Below)** into the position marked by the Side Frame Bar Sticker 'Nylon Flat Bar'. The **Nylon Flat Bar Connectors** join the **Rear Frame** of the Goal to the **Side Frame Bars**.
10. Note that each **Nylon Flat Bar Connector** is installed facing in towards the inside of the Goal
11. Use the **2pc x 80mm Button Head bolts (B Below)** to secure and clamp together the **2pc Nylon Flat Bars** to the top and bottom side of the **Goal Side Bars**.
12. Each bolt has **1pc x 24mm Washer (C Below)** on each side of the frame and a **Nylon LockNut (A Below)** to secure on each. Do not tighten the bolts all the way, tighten enough to hold the parts in place. These will be tightened fully once connected with the **Rear Frame Bars**.
13. Make sure to install the **80mm Button Head bolts** from the underside so that the LockNut and washers are positioned on the top (the side the the Channel showing).



Nylon Flat Bar Installation:

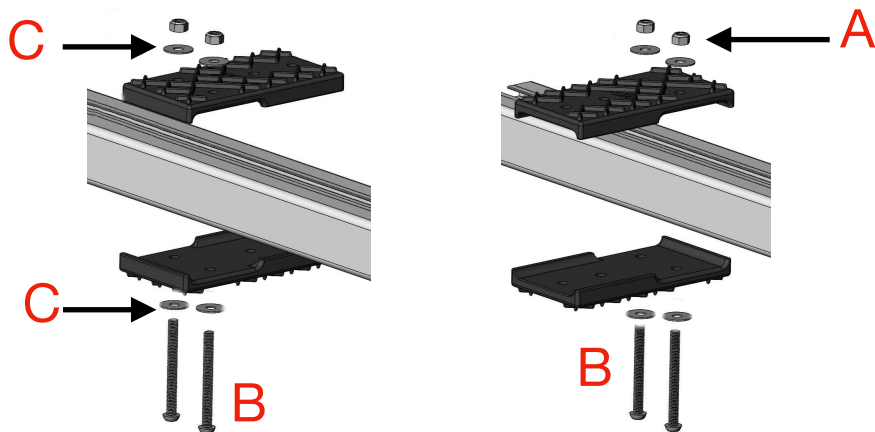

14. Repeat for the other side (See both sides above). See finished **Side Frame Bar Assembly** at **A** and **B** Below. Keep the **LockNuts** on the **Nylon Flat Bar Connectors** loosely tightened at this stage, tight enough to hold the **Nylon Flat Bar Connector** in place, but not fully tightened.
15. The Assembled **Side Frame Bars** are ready when assembled with (1) **Eye Bolt Anchors with Rope Handles**, (2) **Frame Cable Bolt with Washers and LockNut**, (3) **Nylon Flat Bar Connectors** and (4) **Rear Foam Bumpers**. See image A & B Below



Assembled Side Bars completed (see image above):

- (1) Eye Bolt Anchors (both facing outwards),
- (2) Frame Cable Bolt with Washers and LockNut
- (3) Nylon Flat Bar Connectors (both facing inwards, in opposite direction to the Eye Bolt Anchors)
- (4) Rear Foam Bumpers.

NOTE: Ensure that all parts are installed and tightened firmly and securely, but do not overtighten so much so as to deform the ALU Frame parts or the Nylon parts.

Step 4: Join the Assembled Rear Frame Bar (C) with the 2pc Assembled Side Bars (A)

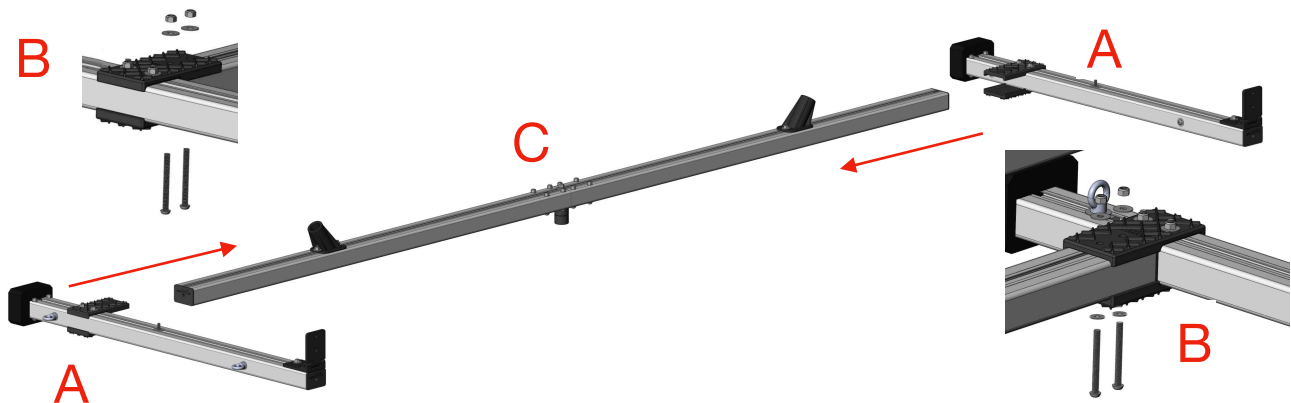

1. Lay the Assembled **Rear Frame Bar (C above)** and the **2pc Assembled Side Bars (A above)** on the ground in position shown below.
2. Slide the Assembled Side bar **Nylon Flat Bar Connectors** into the Assembled **Rear Frame Bar Ends**, making sure that the 2 Pre-drilled M8 Holes on each end of the **Rear Frame Bars** line up perfectly with the 2 Holes in each of the **Nylon Flat Bar Connectors**. See the diagrams show in the images above for assembly details.
3. Install **2pc x 80mm Button Head Bolts** and **2pc x 24mm Flat Washers** with **2pc x Nylon Lock Nut (B Above)**, into the **Nylon Flat Bar Connectors** on each side of the Goal. There should be 2pc x 24mm Flat Washer on both the top and bottom side of the Flat Bar Connector. Insert the Bolts so that the Button head is installed from the underside of the Goal (B Above), and with the Washer and Nylon Lock Nut on the top side of the goal (B Above).
4. Tension all the Nuts and Bolts on both sides of the the **Nylon Flat Bar Connectors** so that they are firmly tensioned with the supplied hand tools as per the image below.
5. Repeat for the other side.
6. Double check that both Sides are securely fastened (see image below).

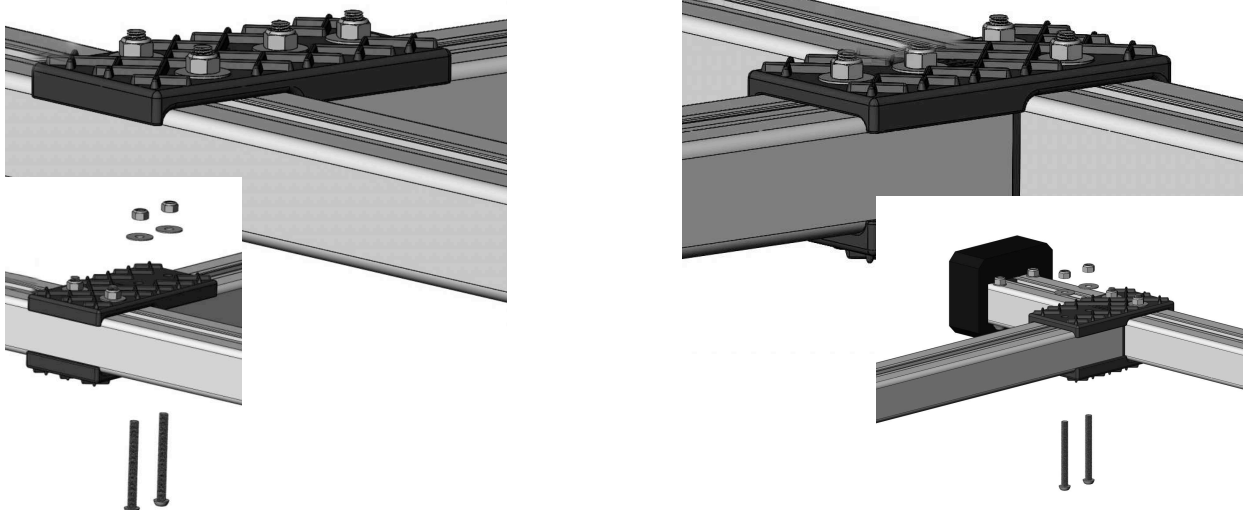

Step 5: Join the Assembled Front Frame (A Below) with the Upright Frame Bars (B Below) using the Nylon Frame Corners (C Below):

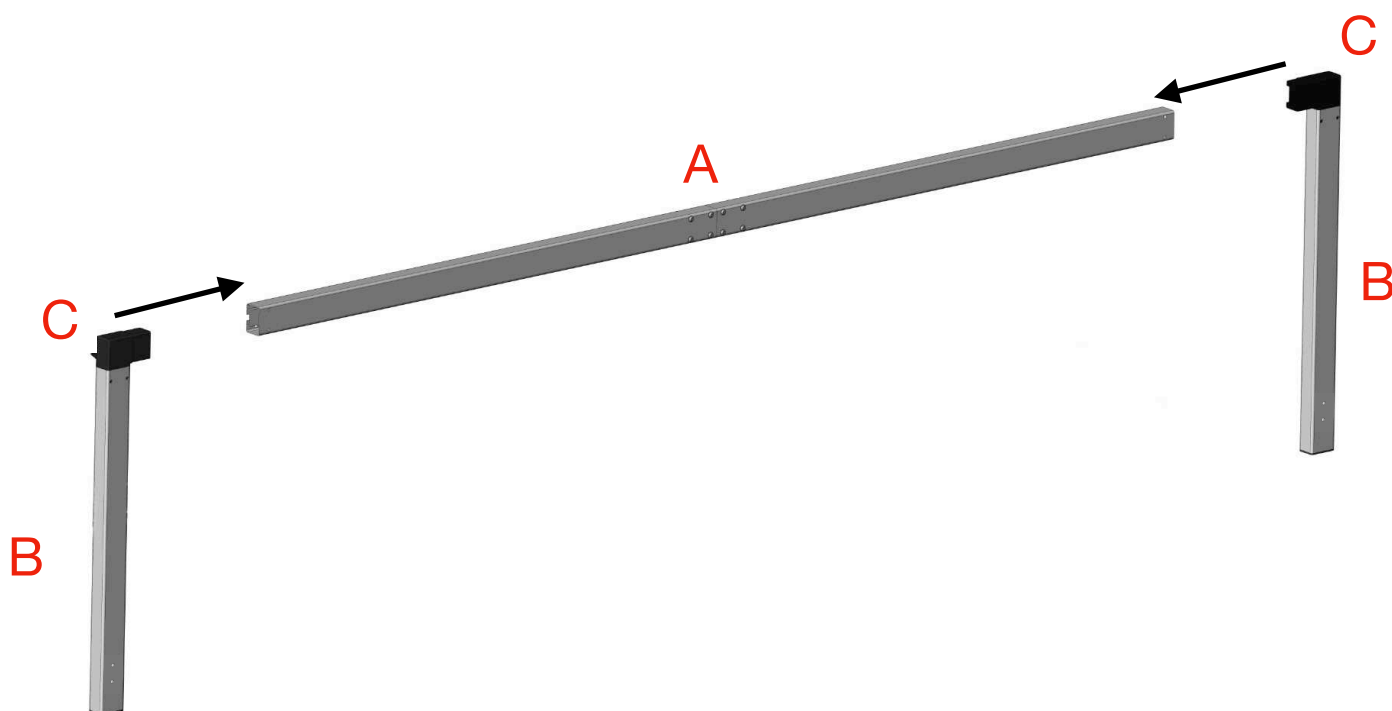

1. Insert the **Nylon Frame Corners** (C above) into both ends of the **Assembled Front Frame Bar** (A Above). The **Nylon Frame Corners** may require a gentle tap with a soft mallet to seat correctly in place inside the Ends of the Frame.
2. Using the supplied **2pc x 60mm Button Head Bolts** (each side) secure the **Nylon Frame Corners** to the **Front Frame Bars** (D Below)). Make sure that the button head bolts are inserted into the frame from the side without the Channel (D Below).
3. Join the **Upright Frame Bars** (D Below) to the **Nylon Frame Corners** on each side, using the **2pc x 60mm Button Head bolts** to secure in place. There should be **1pc x 16mm Flat Washer** both under the bolt head and also under the **Nylon Lock Nut** (D Below).

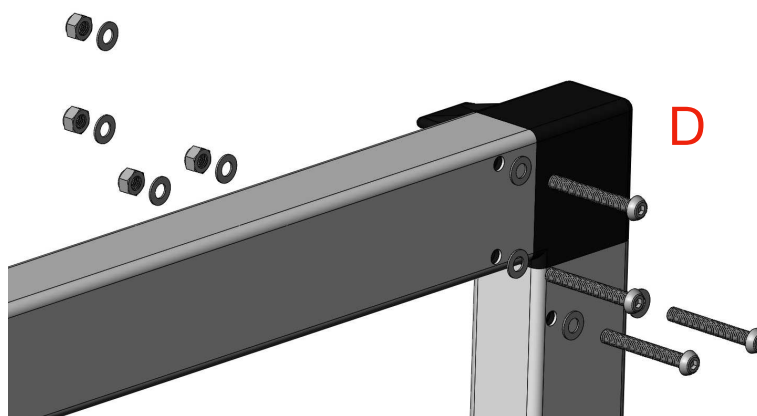

Step 6: Install the Assembled Front Frame to the Nylon Hinges:

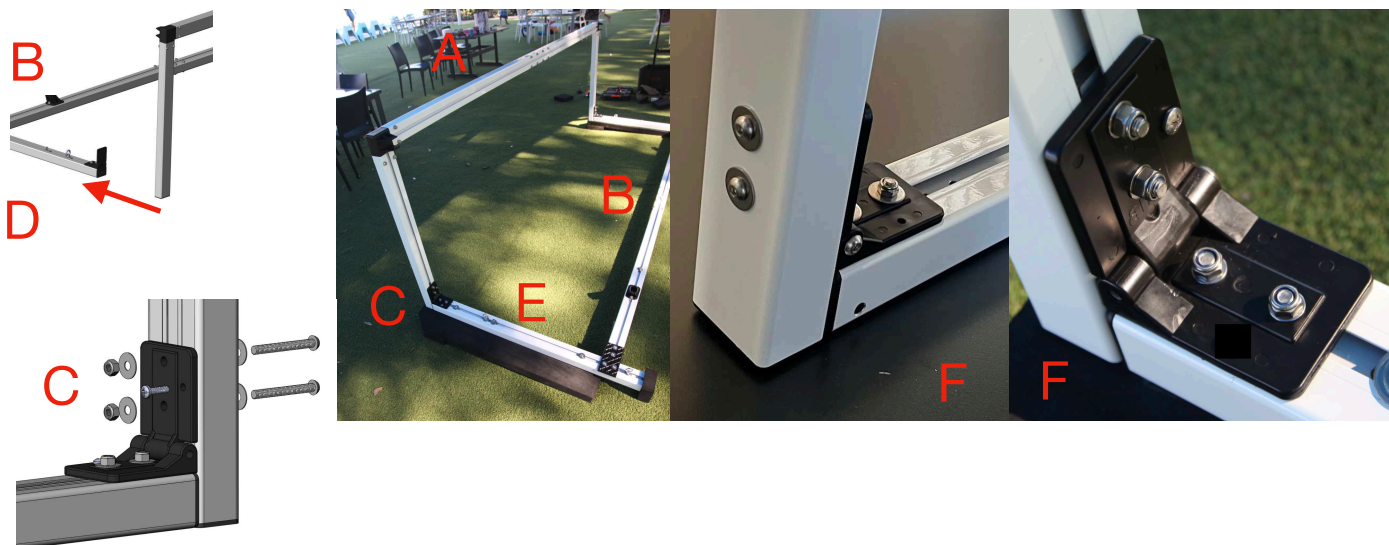

1. Lay the **Assembled Front Frame Bars (A Above)** in position next to the Assembled **Side Frame Bars (B above)**, lining up the Lower Section of the Front Frame Bars with the Nylon Hinge (D Above).
2. Using the **2pc x 80mm Button Head Bolts**, with **2 x 24mm Washers** and **LockNuts**, secure the **Front Frame Assembly (A)** to the **Side Goal Bars with Rear Frame (B + E)**.
The **2pc x 80mm Button Head Bolts** are pushed through the two M8 Holes in the Lower part of the **Front Frame** and then through the Upper Section of the **Nylon Hinge (C Above)**.
There is 1pc x 24m Washer on each side of the frame. Ensure the bolt head is at the front.
3. Repeat above for the other side of the Goal.
4. Tension the upper and lower **Nylon LockNuts** in the **Nylon Hinge** so that they are all firmly connected in place (F Above).

Step 7: Install the Large Foam Flotation Pads (A Below) to the Frame Side Bars (B Below):

1. Locate **1pc Large Foam flotation pad (A Below)**, as well as **2pc x 50mm Flat Washer**, **2pc x 100mm Button Head Screws**, **2pc x 24mm Flat Washers**, and the **2pc x 32mm Flat Washers** for each side of the Goal (E Below). Note: The cut-off foam corners are positioned on the outside of the **Front** of the Goal (B Below).
2. Position the **Large Foam Flotation Pad** under each **Goal Frame Side Bar (A & B Below)** and install the Pads to the Goals using the Hardware provided into the 2pc predrilled M8 holes (D Below) located on each **Side Bar (E Below)**.
3. Two hole positions are available on the **Side Bars (D Below)**; using the rear Hole position will make the Floats flush with the Front Frame when in use, while the Front Hole will bring the Floats 30mm in front of the Front Frame when erected, offering more protection for the front edge of the frame when folded and in storage.

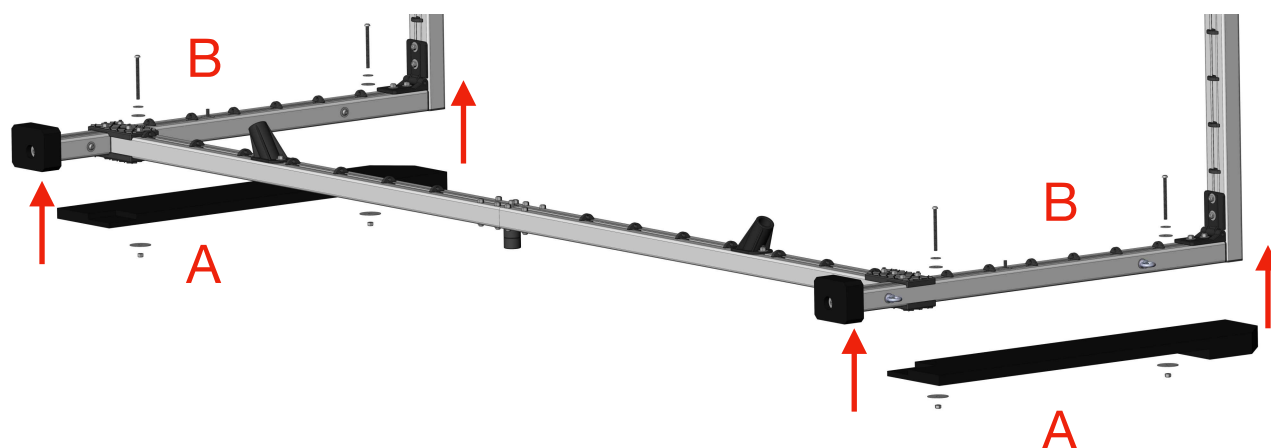

Step 7: Foam Flotation Installation (Continued):

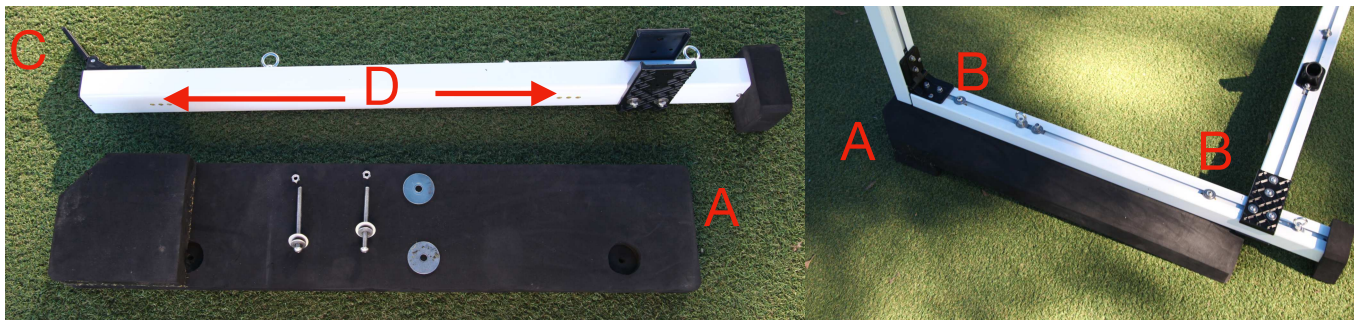

4. Place **1pc x 24mm Flat Washer** onto the **1pc x 100mm Button Head Screw**, then assemble onto the Screw **1pc x 32mm Flat Washer**.
5. Insert the **100mm Button Head Screw with Washers** in place from the top of the **Side Bar channel** down and through the Pre-drilled holes in the Foam (B Below).
6. Then place **1pc x 50mm Large Washer** on the other side (underside) of the Foam and use the **Nylon LockNut** to secure in place (C Below).
7. **The Above image** shows the Bolts being installed with the **1pc x 24mm Flat Washer** and **1pc x 32mm Washer** under the head of the Bolt, and with the **50mm Flat Washer** installed under the LockNut on the underside of the Foams, under the Goal.

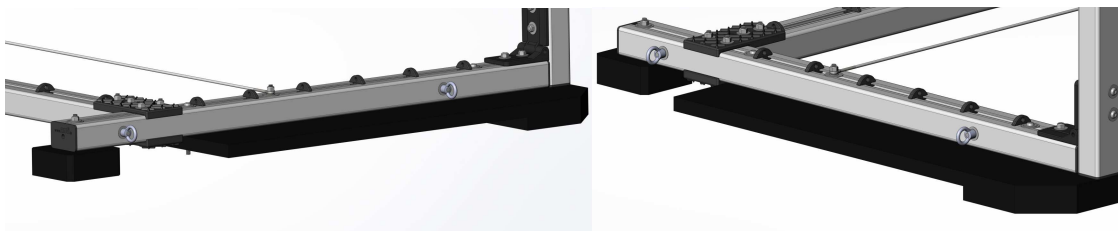

Step 8: Install the Black PVC Bows/Pipes to the Goal:

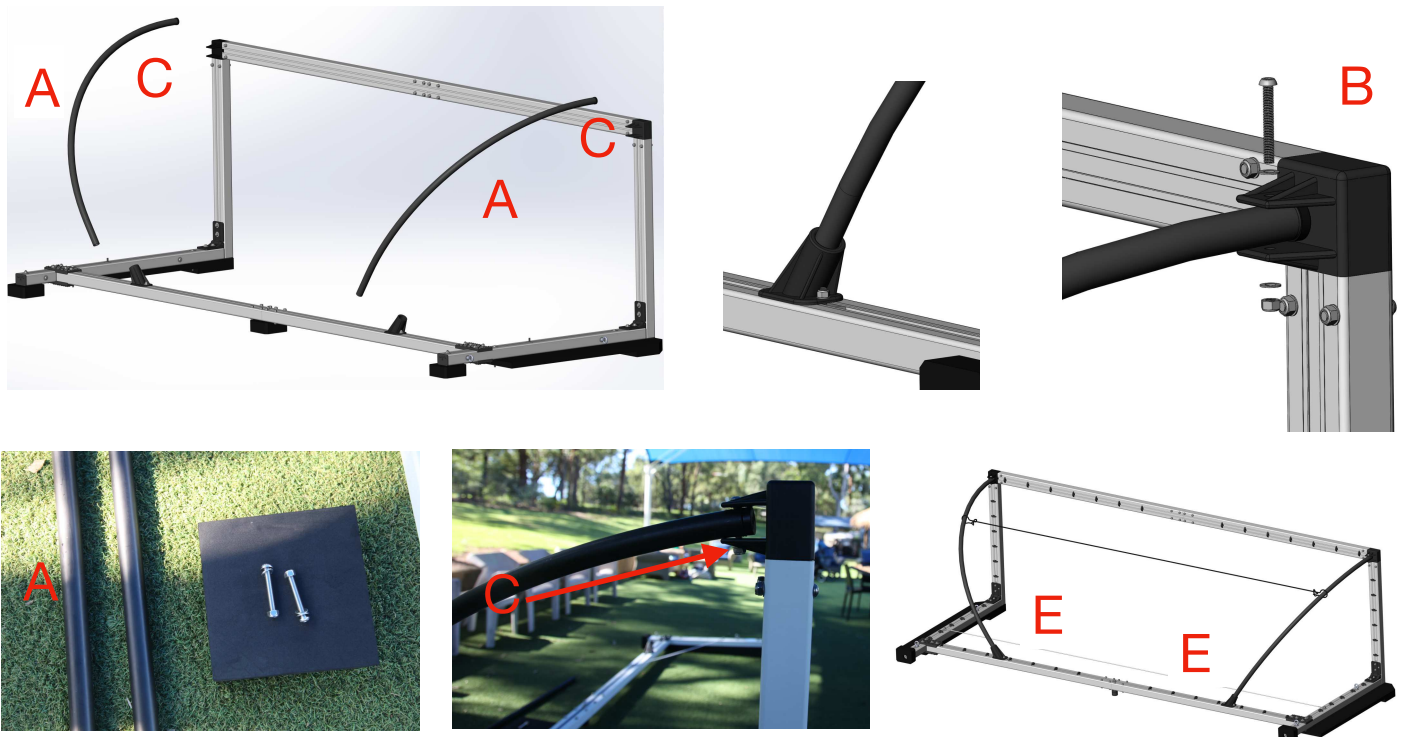

1. Locate the **2pc PVC Black Bows (A above)**, as well as **2pc x 60mm Button Head bolts, 2pc 16mm Flat Washers** and **2pc x M8 Nylon LockNuts (B Above)**.
2. Install the **PVC Bows** to the **Nylon Corner Connector** using **1pc x 60mm Button Head bolt, 2pc x 16mm Flat Washer** and **1pc Nylon Locknut** each side (B above). There should be **1pc x 16mm Flat Washer** both under the head of the Bolt and under the LockNut. Note that one end of the Bows is Pre-Drilled to accept the **60mm Button Head Bolts with Flat Washers and LockNuts (C Above)**.
3. Bend the **PVC Bows** and insert into the **Nylon Bow Connectors** located on the **Rear Goal Frame bar (D above)**. Be careful to hold firmly in place when inserting and removing under tension.
4. Ensure that the **PVC Bows** are firmly seated all the way into the **Nylon Bow Connectors (E Above)**

Step 9: Install the Frame Cable to the Side Frames

1. Remove 1pc x LockNut from the Foam Flotation on each side and swing the float to get access to the frame cable bolt head.
2. Locate the **1pc x 3m White Frame Cable with Eye Terminals (A Below)** and remove the **1pc x Nylon LockNut** and **1pc x 16mm Flat Washer** from each of the **Frame Cable Bolts** already installed to the **Side Frame Bars** shown below (B Below). Make sure to leave **1pc x 32mm Flat Washer** and **1pc x 16mm Flat Washer** on the **Frame Bolt** in place (F Below).
3. Attach the **Frame Cable Eye Terminal with Cable (E)** on top of the **Washer** (remaining on the bolt). On top of the **Frame Cable Eye Terminal** attach **1pc x 16mm Flat Washer** and **1pc Nylon LockNut** onto the Frame Cable Bolts on each side of the Goal, and tighten in place as shown below (G Below).
4. Reinstall the Rear Foam Flotation Bolts and LockNuts to the goal on each side.

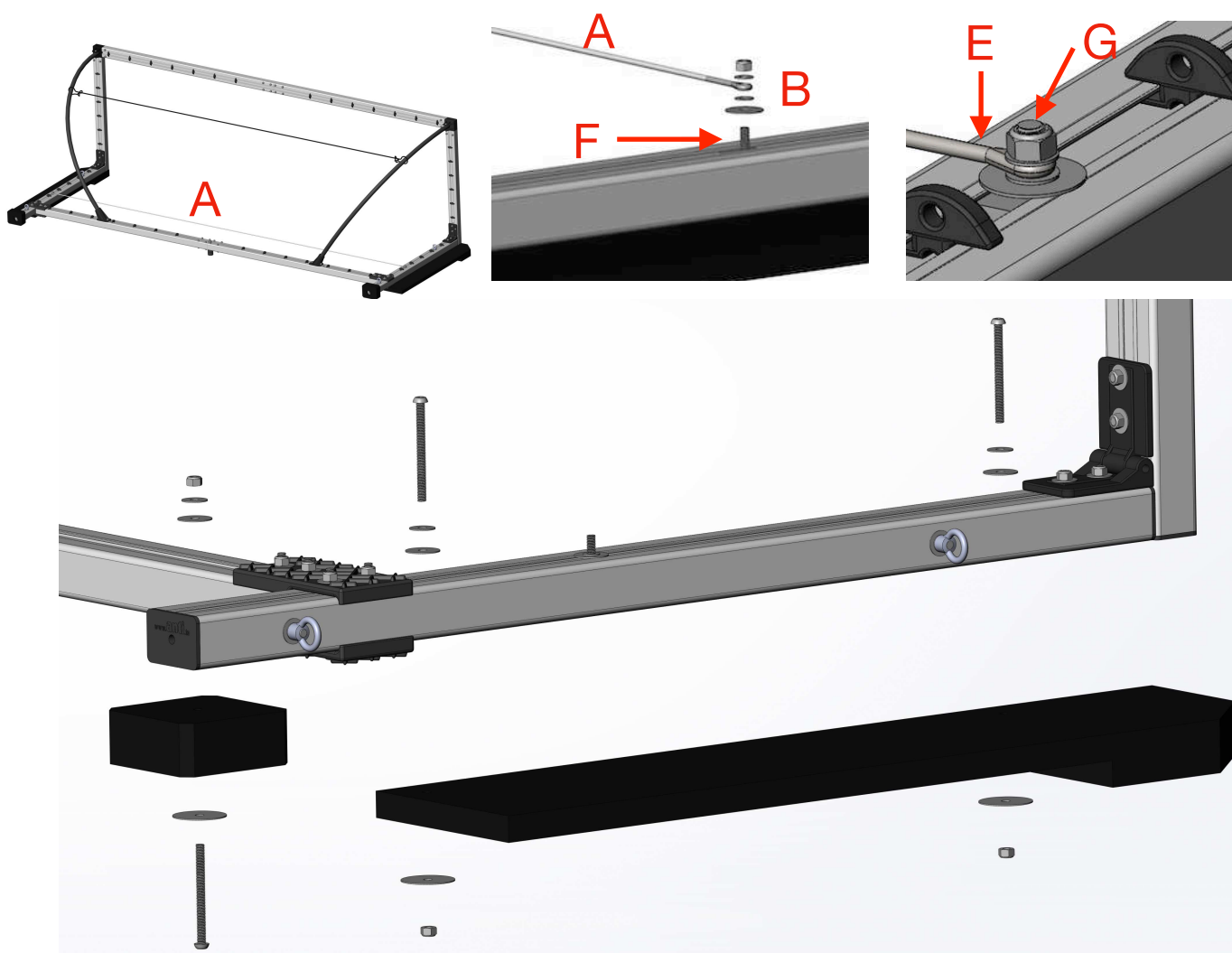

Step 10: Install the Net to the Goal:

1. Locate the **Black or White Net** and the plastic bag with **Black Net Clips**.
2. With another person holding the **Net**, locate the front top corners of the Net and secure in place with **1pc Net Clip** on either side of the outside of the Bows (**shown below as 1**).
3. The **Net Clips** are installed by holding the Reinforced edge of the the Net inside the Frame Channel and then pushing the Net Clip into the channel and testing the Net Clip so that the wings of the Net Clip engage inside the Frame Channel and are positioned at 12 o'clock and 6 o'clock respectively.
Note: Push the Reinforced Edge of the Net into the ALU Channel first and tuck it into one side of the Channel, and then twist the **Net Clips** to lock the wings into place. You may need to use a pair of pliers to help to hold the Net Clips while you twist into place. Ensure that the Net Clips are locked firmly against the Frame Channel.
4. Stretch the Net out over the top of the **Black PVC Bows** and count 7 Squares from the front frame along the top corner edge of the Net. At the 7th Square from the front frame, the **PP Bow** is removed from the **Nylon Bow Holder** and then threaded through from inside the Net to the outside of the Net (highlighted in Red Square below). Reinstall the **PVC Block Bow** into the **Bow Holders**.
5. Pull the sides of the Net down towards the **Nylon Hinge** and secure the lower section of the Net onto the front of the Side Bars using **1pc Net Clip** each side (shown below as 2).
6. Pull the rear of the Net towards the **Rear Frame** and install **1pc Net Clip** in the position marked below as 3.
7. Install **2pc Net Clips** on either side at the middle point of the Front Frame and the Rear Frame (marked 4 below).
8. Working around the Goal install the Net Clips in all the remaining spaces at every second square of Net to secure the Net to the Goal.

NOTE: It is very important to thread the Net through the location shown in 1 Below (7th Square from the front). Failure to Assemble the Net According to these instructions will void the Warranty.

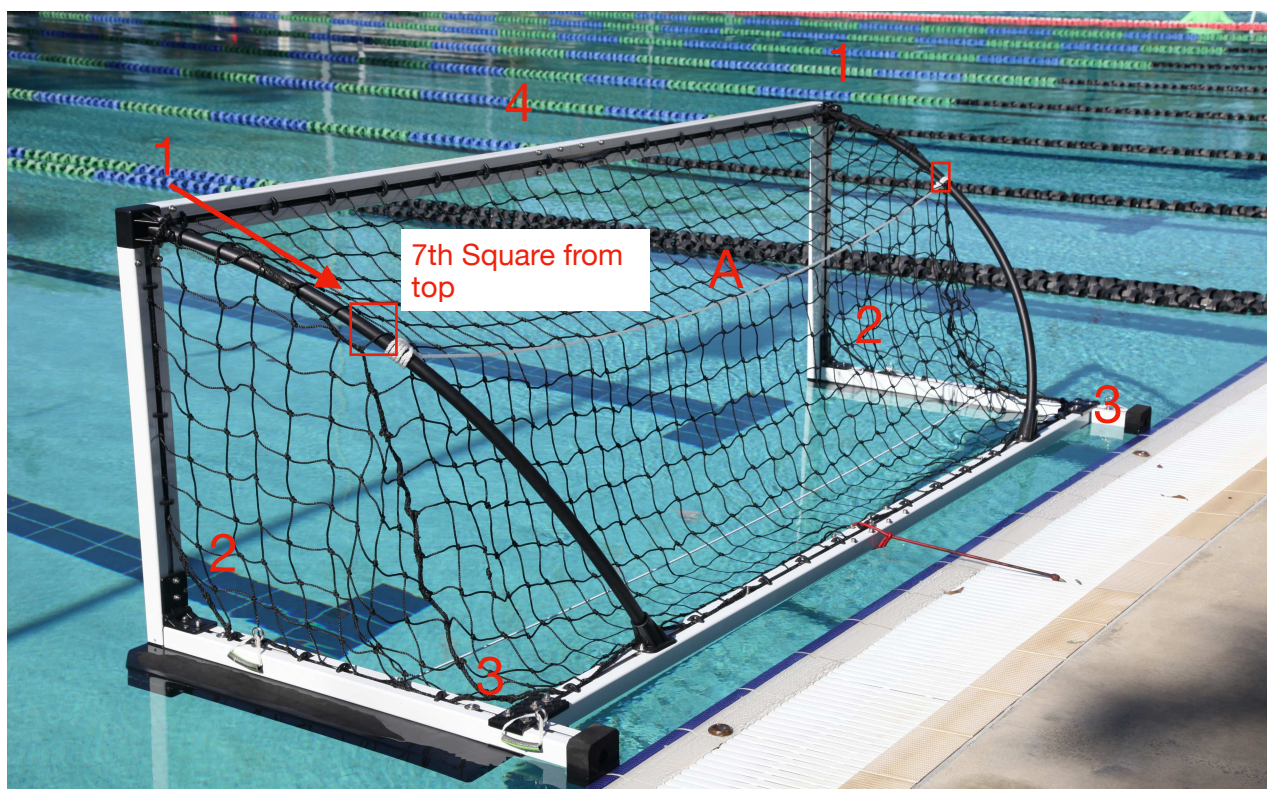

NOTE: Gen5 Global Goals have improved (different) Rear bumpers to the image shown above.

Step 11: Install the Net Rope:

1. Locate the **Nylon Net Rope** supplied, and install the **Rope** to one side of the Black Bows at the 7th Net Square shown above, then thread the Rope in and out of the Net towards the other side of the Bows and tie in place on the other Black PVC Bow. Refer to image above (A above).

Step 12: Check work done:

1. Working around the goal make sure that each fitting is secure and properly tightened in place.
2. Peel off/ remove the pre-installed stickers from the Goal Side Bars.

The Goal is now ready to use and enjoy.

How to Fold the Goal:

To fold the Goal simply pull out the Black PVC Bows from two the Rear Bow holders and fold the goal together for storage. We recommend to place one foot on the Bow Holder/Rear Frame area and then pull the Black PVC Bows out with two hands. A bungee cord or small strap can be used to keep the two halves together when folded.

Be careful when pulling out the PVC Bows from the Bow Holders as they are under tension and may snap back into their original straight position when removed from the Holders. Also, note that the Front Frame will fall down when the PVC Bows are removed from the Bow Holders, we recommend to hold the Front Frame in place while the PVC Bows are removed from the Bow Holders.

Important Notes:

- **See separate Global Goal User Manual for details on care and maintenance of the Goals.**
- Periodically check that all fittings on the Goal are securely tightened, particularly after first 1-2 weeks of initial use.
- Failure to follow these above directions in full may void the Warranty.
- Be careful when pulling out the PVC Bows from the Bow Holders as they are under tension and may snap back into their original straight position when removed from the Holders.
- When the PVC Bows are removed from the Bow Holders, the Front frame will be unsupported and should be carefully let down, try to avoid the Front frame dropping to avoid damaging the Goal.
- Correct installation of the Net is important, please follow Net installation steps closely.

Annex 1.0 Carton Contents:

Carton A:

- Aluminium Frame Bars (Rear Frame Bars x 2, Front Frame Upright Bars x 2, Side Frame Bars x 2, Front Frame Bars x 2)
- Aluminium Frame Inserts x 2 (1pc Located inside the Rear Frame Bar, 1pc inside the Front Frame bar)
- Black Nylon Frame Corners x 2
- Pre-assembled Eye Anchor Bolts x 2
- Pre-assembled Frame Cable Bolts with Washers and Locknuts x 2 (1 x Bag)
- Nylon Hinges x 2 (Installed on Side Frame Bars)
- Nylon Rope
- Tools (1pc Ratchet Spanner & 1pc Hex Hand Tool) and Instructions



Rear Frame bars x 2

Front Frame upright bars x 2

Side Frame bars x 2

Front Frame bars x 2

Carton B:

- Large Black Foam Flotation pads x 2
- Black PVC Bows x 2 (Black Plastic Pipe)
- Bolts and Screws (1 x Bag)
- Washers (1 x Bag)
- LockNuts (1 x Bag)
- Nylon Bow Holders x 2
- Rear Side Frame Foam Bumpers x 2
- Rear Frame Foam Bumper x 1
- White Frame Cable 3m (1 x Bag)
- Nylon Flat Bar Connectors (1 x Bag with 4pc inside)
- Black Net Clips (1 x Bag)
- Black Net x 1



Annex 2.0 Assembly Hardware:



Annex 3.0 Identification of the Goal Frame Parts:

Below images show all of the Goal Frame Parts as they are included in the Cartons from Factory.



Note: The Front & Rear 2pc Frame Bars are the same length, the 2pc Goal Front Frame bars have the Anti Stickers attached, while the 2pc Rear Frame Bars do not have the Anti stickers attached. The Rear Frame bars have the Bow Holder position marked on the frame.

Annex 4.0 High Resolution Images of Assembled Global Anti Goal

